

# Jetox™-ND

## INSTRUCTION FOR USE

- The JETOX™-ND system is intended for use in wound management for cleansing and debridement.
- The JETOX™-ND creates a jet stream from sterile Saline solution and compressed medical oxygen.
- The microdroplets created by JETOX™-ND are between 5-20 microns and are accelerated up to 200 m/s.
- The use of the JETOX™-ND should be supervised by trained wound care professional.

### Indications:

Wound cleansing and debridement where, in the opinion of the practitioner, debridement and lavage irrigation are required.

### Installation

- Connect the oxygen tube to the oxygen source.
- Assure that the valve is in closed position.
- Open the JETOX™-ND package.
- Screw the other side of the oxygen tube to the JETOX™-ND's luer.
- Insert the spike to the solution bag. The bag may be placed near the treated area.
- Affix the shield sleeve on to the JETOX™-ND nozzle, up to the grooves.
- The shield is designed to maintain the optimum treatment distance.

### Operation

- Open the oxygen source.
- Gently bring the shield into contact with the wound area to be treated.
- Open the valve.

### End of treatment

- At end of treatment close the valve.
- Close the oxygen source.
- Once again assure that the oxygen source is closed.

### TECHNICAL SPECIFICATIONS

Liquid (solution)	Saline 0.9% sodium chloride
Oxygen tube length	2.28 meters (9.0")
Solution tube length	1.05 meters (4.2")

### SETTINGS FOR OXYGEN SOURCE

L-min @ 9 = 4 psi	L-min @ 11 = 6 psi
L-min @ 13 = 9 psi	L-min @ 15 = 12 psi

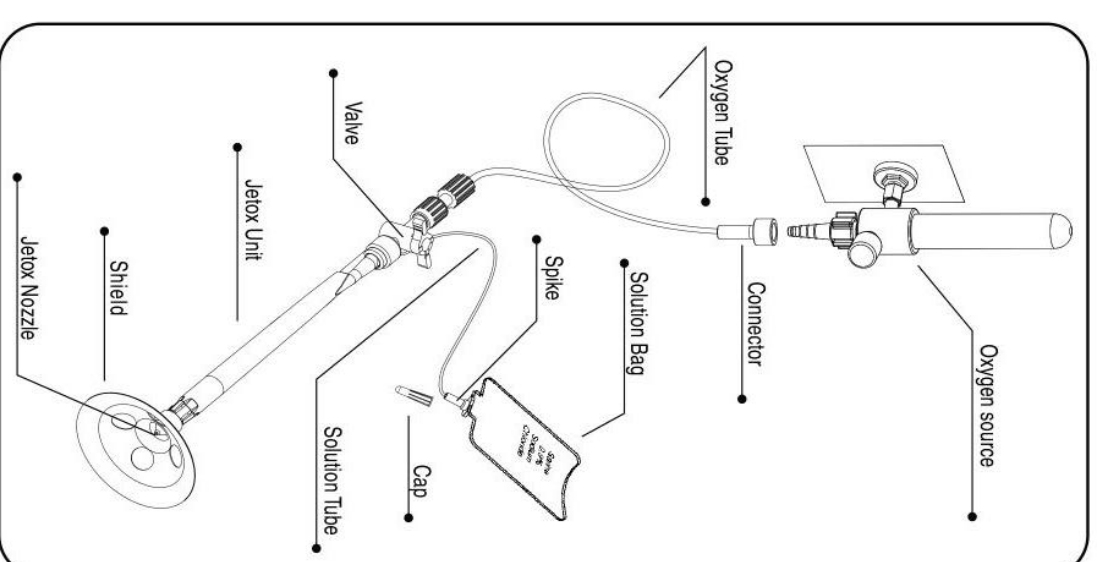

**STERILE EO**

Sterilized by E O



Do not use after the date printed on the label.



Single Use Only. Do Not Reuse.



The JETOX™-ND is sterile within a sterile package. Do not use if the package is opened or damaged or appears damaged.

**Warnings:**

Use the JETOX™-ND unit once only and then discard. Using the unit more than once may cause infection and contamination.

Dispose of used materials safely, according to your local regulations.

Connect to oxygen source using a standard luer connection.

If the oxygen source is an oxygen cylinder, the connection must be through a pressure regulator, adjusted to a pressure of 50 psi.

The JETOX™-ND system must not be used for any use other than wound management for cleansing and debridement.

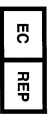

European Authorized Representative:  
Mr. C. Fioretti  
c/o Mintra 21 Rue du Mont Blanc 1201  
Geneva, Switzerland



TavTech Ltd.  
P.O.Box 1167 Yehud, Israel, 5630417  
Customer Service:  
Tel: +972-3-5360515; Fax: +972-3-6321237;  
e-mail: [tavtechy@tav-tech.com](mailto:tavtechy@tav-tech.com)  
[www.jetox-tavtech.com](http://www.jetox-tavtech.com)